

| REVISION HISTORY |                    |            |          |
|------------------|--------------------|------------|----------|
| REV.             | DESCRIPTION        | DATE       | APPROVED |
| A                | I.S.O. CERTIFIED   | 09/12/1999 | KAH      |
| B                | REDRAWN w/o CHANGE | 06/21/2006 | KAH      |

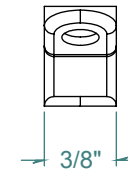
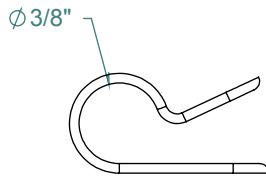
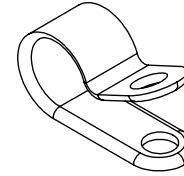
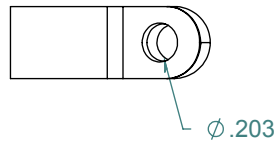

DIMENSIONS ARE IN INCHES UNLESS SPECIFIED. TOLERANCES ARE:  
 FRACTIONS +/- .015  
 2 PLACE DECIMAL +/- .010  
 3 PLACE DECIMAL +/- .005  
 ANGLES NOTED  
 \* Call-Out is reference only and may vary, minimally, beyond standard tolerances.

**ARK-PLAS PRODUCTS, INC.**

**APTC37D0375**  
**3/8" WIDE x 3/8" I.D. x Ø .203 MOUNTING HOLE**  
**CABLE CLAMP**

FREE SAMPLES ARE AVAILABLE FOR TESTING. CONTACT CUSTOMER SERVICE

PROPRIETARY AND CONFIDENTIAL  
 THE INFORMATION CONTAINED IN THIS DRAWING IS THE SOLE PROPERTY OF  
 ARK-PLAS PRODUCTS, INC. ANY REPRODUCTION IN PART OR AS A WHOLE  
 WITHOUT THE WRITTEN PERMISSION OF ARK-PLAS PRODUCTS, INC. IS PROHIBITED.

MATERIAL:  
**NATURAL NYLON**  
 FINISH: Ark-Plas Standard  
 (Unless Specified)

|                      |            |                            |                        |
|----------------------|------------|----------------------------|------------------------|
| JOB #                |            | PRINT ISSUE DATE: 06/21/06 |                        |
| SIZE<br><b>A</b>     | SCALE: 2:1 | SHEET: 1 OF 1              | REV. LEVEL<br><b>B</b> |
| DO NOT SCALE DRAWING |            | DRAWN BY: <i>KAH</i>       |                        |